

# DG Blue

Set-back vortex impeller

DESIGN BY

*pininfarina*

All product images are indicative only



## General characteristics

set-back vortex impeller	
motor power	0,3 ÷ 0,74 kW
poles	2
discharge	GAS 1½" vertical
free passage	max 40 mm
max flow rate	7.7 l/s
max head	11.6 m

## Electromechanical assembly

Electromechanical assembly in EN-GJL-250 cast iron, for submerged operation, fitted with 2 (two) opposing mechanical seals in silicon carbide and alumina graphite in oil sump, and V-ring in direct contact with the liquid. Ecological dry motor. Pump body in single casting with motor casing.

## Applications

Used with soiled biological wastewaters and sewage. Suitable and reliable for domestic use and residential applications.

## Construction materials

Case	Cast iron EN-GJL 250
Impeller	Technopolymer
Nuts and bolts	Stainless steel - Class A2-70
Standard gasket	Rubber - NBR
Shaft	Stainless steel - AISI 420
Paint type	Ecological bicomponent epoxy (medium thickness 80 µm)
Set of standard mechanical seals	One silicon carbide mechanical seal (SiC) and one alumina graphite mechanical seal (AL), V-ring

## Operating limits

Maximum operating temperature	40 °C
PH of treated fluid	6 ÷ 14
Viscosity of treated fluid	1 mm <sup>2</sup> /s
Maximum immersion depth	20 m
Density of treated fluid	1 Kg/dm <sup>3</sup>
Maximum acoustic pressure	70 dB
max starts per hour	30

Models available in IECEx certified version

Ex nA IIC T3  
Ex nA nC IIC T3

# DG Blue

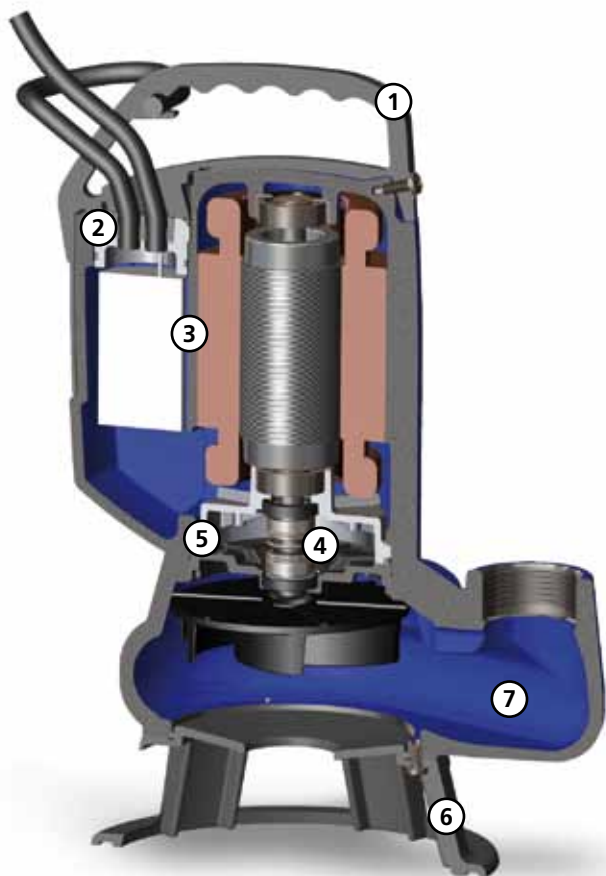

## Lifting handle

Ergonomic technopolymer lifting and carrying handle. Clip floatswitch adjustment.



## Cable gland System

Innovative cable gland system with twin O-rings to ensure maximum tightness

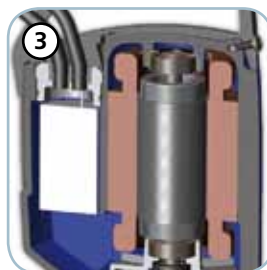

## Motor and electrical accessories

Dry motor with thermal protections. Internal startup capacitor.



## Mechanical seals

One silicon carbide mechanical seal (SiC) and one alumina graphite mechanical seal (AL), V-ring in direct contact with the liquid

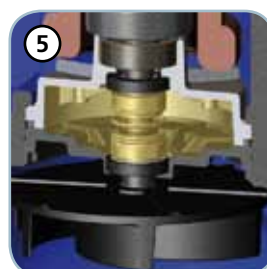

## Oil sump

Oil sump which guarantees longer mechanical seal lifetime, and is easily accessible thanks to a patented system to simplify maintenance procedures



## Support foot

Support foot in impact-resistant polypropylene

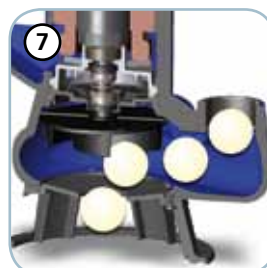

## Free passage

Full free passage allowing the expulsion of solids and preventing fouling of the impeller

# DG Blue

## Models with vertical GAS 1½" threaded discharge - 2 poles

### Performances

	l/s	0	1	2	3	4	5	6	7
	l/min	0	60	120	180	240	300	360	420
	m³/h	0	3.6	7.2	10.8	14.4	18.0	21.6	25.2
① DG Blue 40/2/G40V A1BM/50		6.0	5.2	4.0	2.8	1.7			
② DG Blue 50/2/G40V A1BM/50		7.6	6.7	5.5	4.2	2.9	1.6		
③ DG Blue 75/2/G40V A1BM/50		10.1	9.5	8.5	7.2	5.7	4.2	2.6	
④ DG Blue 100/2/G40V A1BM/50		11.6	11.2	10.2	9.1	7.6	6.0	4.3	2.7

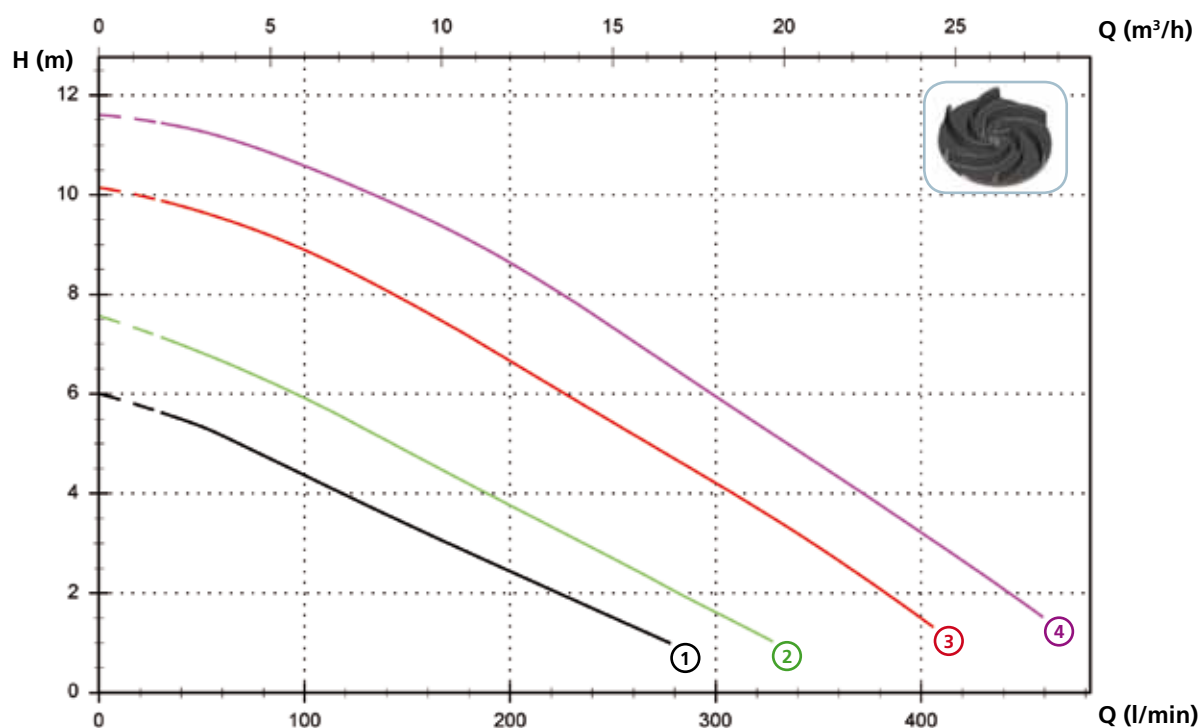

### Technical data

	V	Phases	P1 (kW)	P2 (kW)	A	Rpm	Ø	Cable (*)	Free passage
① DG Blue 40/2/G40V A1BM/50	230	1	-	0.3	2.3	2900	G 1½"	A	40 mm
② DG Blue 50/2/G40V A1BM/50	230	1	-	0.37	2.8	2900	G 1½"	A	40 mm
③ DG Blue 75/2/G40V A1BM/50	230	1	-	0.55	4.1	2900	G 1½"	A	40 mm
④ DG Blue 100/2/G40V A1BM/50	230	1	-	0.74	5.6	2900	G 1½"	A	40 mm

(\*) A = H07RN-F 3G1 - 5 m cable length with schuko plug. Optional 10 m cable length with schuko plug.  
 Attention: Standard EN 60335-2-41 requires the use of a 10 m cable length in outdoor applications

# DG Blue

## Versions available

(Key to versions on page 16)

	Electrical variants										Cooling				Mechanical seals			
	N A E	T C	T C D	T C D T	T C D G T	T C G	T C S T	T C S G T	T S	T R G	N	CC CCE	FT	C G F T	2SIC	SICM	SICAL	2SICAL
DG Blue 40/2/G40V A1BM/50						●					●						●	
DG Blue 50/2/G40V A1BM/50						●					●						●	
DG Blue 75/2/G40V A1BM/50						●					●						●	
DG Blue 100/2/G40V A1BM/50						●					●						●	

## Overall dimensions and weights

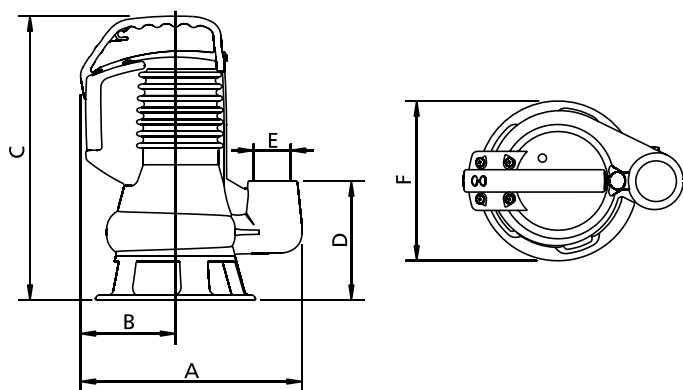

	A	B	C	D	E	F	kg
DG Blue 40/2/G40V A1BM/50	265	115	335	140	G 1 1/2"	190	12.5
DG Blue 50/2/G40V A1BM/50	265	115	335	140	G 1 1/2"	190	13
DG Blue 75/2/G40V A1BM/50	265	115	335	140	G 1 1/2"	190	15
DG Blue 100/2/G40V A1BM/50	265	115	335	140	G 1 1/2"	190	15.5

Dimensions in mm

All weights and dimensions are indicative only

## Packaging dimension

	A	B	C
DG Blue 40/2/G40V A1BM/50	240	200	400
DG Blue 50/2/G40V A1BM/50	240	200	400
DG Blue 75/2/G40V A1BM/50	240	200	400
DG Blue 100/2/G40V A1BM/50	240	200	400

Dimension in mm

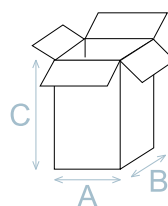

All weights and dimensions are indicative only

## No. pieces per pallet

For DG Blue models each pallet (EUR 1000X1200 mm) is able to take 75 pieces.

## Installations available

